

Replacing Expansion Valve Switch, 3411234, on 1998–2002 Dodge Van or 1991–1995 Dodge Caravan

gpd.

Global Parts Distributors, LLC

TECH TIP

#61

gpdtechtips.com

TOOLS NEEDED

4mm Hex

27mm Ring Spanner

Always Use Eye Protection!

1. Remove old expansion valve from evaporator, carefully removing electrical connectors.

2. With the valve face inlet up (where screws were placed), carefully remove the low-pressure switch using the 27mm ring spanner and refrigerant flow sensor housing using the 4mm hex.

3. Place 3411234 where the inlet is pointing up (where screws holes are located) Turn it to the right to make sure that the green dot is facing you. Remove the green dot and place the tip of the refrigerant flow sensor inside.

4. Put the mounting bracket that holds the refrigerant flow sensor in place, which contains a locating pin. Place the locating pin into the hole and tighten hex bolt to keep refrigerant sensor in place.

5. The opposite side is the location of the low-pressure switch. Screw this into the expansion valve and tighten with the 27mm ring spanner.

3411234

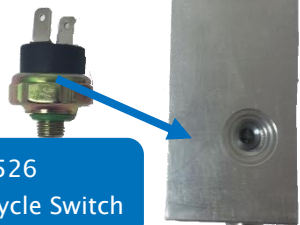
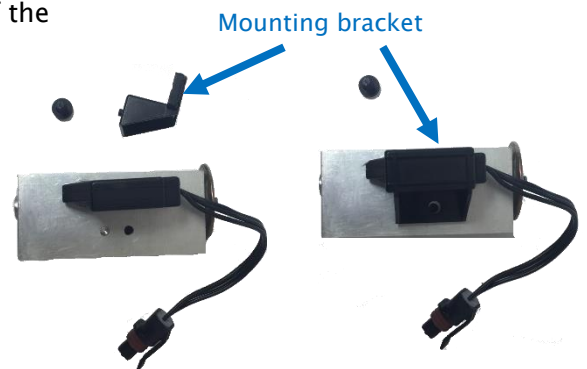
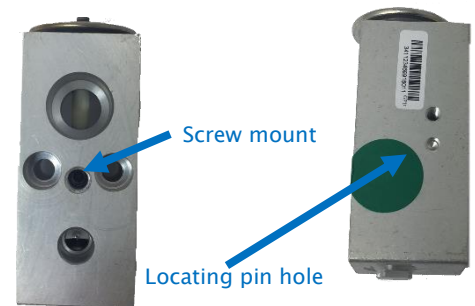
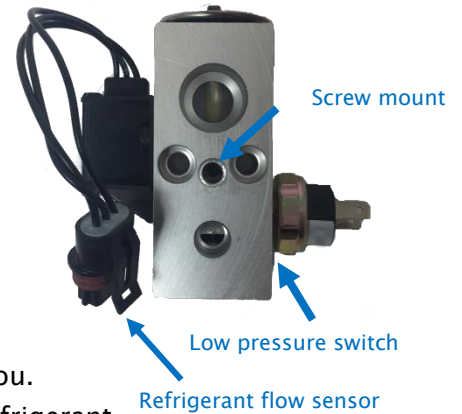

1711526
A/C Clutch Cycle Switch

Manufacturer names, logos and part numbers are for reference only. All prices, taxes and availability are subject to change without notice. This document and any files transmitted with it are confidential and intended solely for the use of the individual or entity to which they are addressed. If you have received this document in error, please delete it immediately. Note that any views or opinions presented in this document are solely those of the author. Any unauthorized review, use, disclosure, or distribution is prohibited. Global Parts Distributors, LLC (gpd) accepts no liability for any damage caused by any virus or other means transmitted by this document. © Global Parts Distributors, LLC (gpd)