

Thermistor Tester 5811551

A thermistor is a sensor that is typically found inside the cabin on the evaporator. It reads and interprets data by detecting the temperature and sending a resistance signal to the AC control module.

A well-functioning thermistor is important because it controls the comfort of the passengers. If a thermistor is faulty it can send the wrong information to the AC control module causing the cabin to be either too hot or too cold. A thermistor tester allows you to detect any problems by plugging in the device and it reads the signal and communicates with the AC control module to test operation, without the need to pull apart the dashboard to get to the thermistor.



1. Locate thermistor connector which is usually located near the bottom of the glove box area.



2. With the ignition off, unplug thermistor

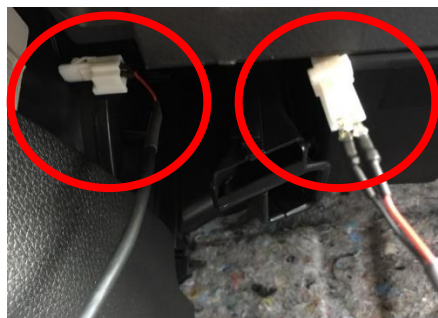

3. Using the universal connections provided, connect into the housings and connect to thermistor tester.



4. Power vehicle on and using the instructions provided, you can measure the resistance coming in from the AC control module or manually control the signal.

Manufacturer names, logos and part numbers are for reference only. All prices, taxes and availability are subject to change without notice. This document and any files transmitted with it are confidential and intended solely for the use of the individual or entity to which they are addressed. If you have received this document in error, please delete it immediately. Note that any views or opinions presented in this document are solely those of the author. Any unauthorized review, use, disclosure, or distribution is prohibited. Global Parts Distributors, LLC (gpd) accepts no liability for any damage caused by any virus or other means transmitted by this document. © Global Parts Distributors, LLC (gpd)